

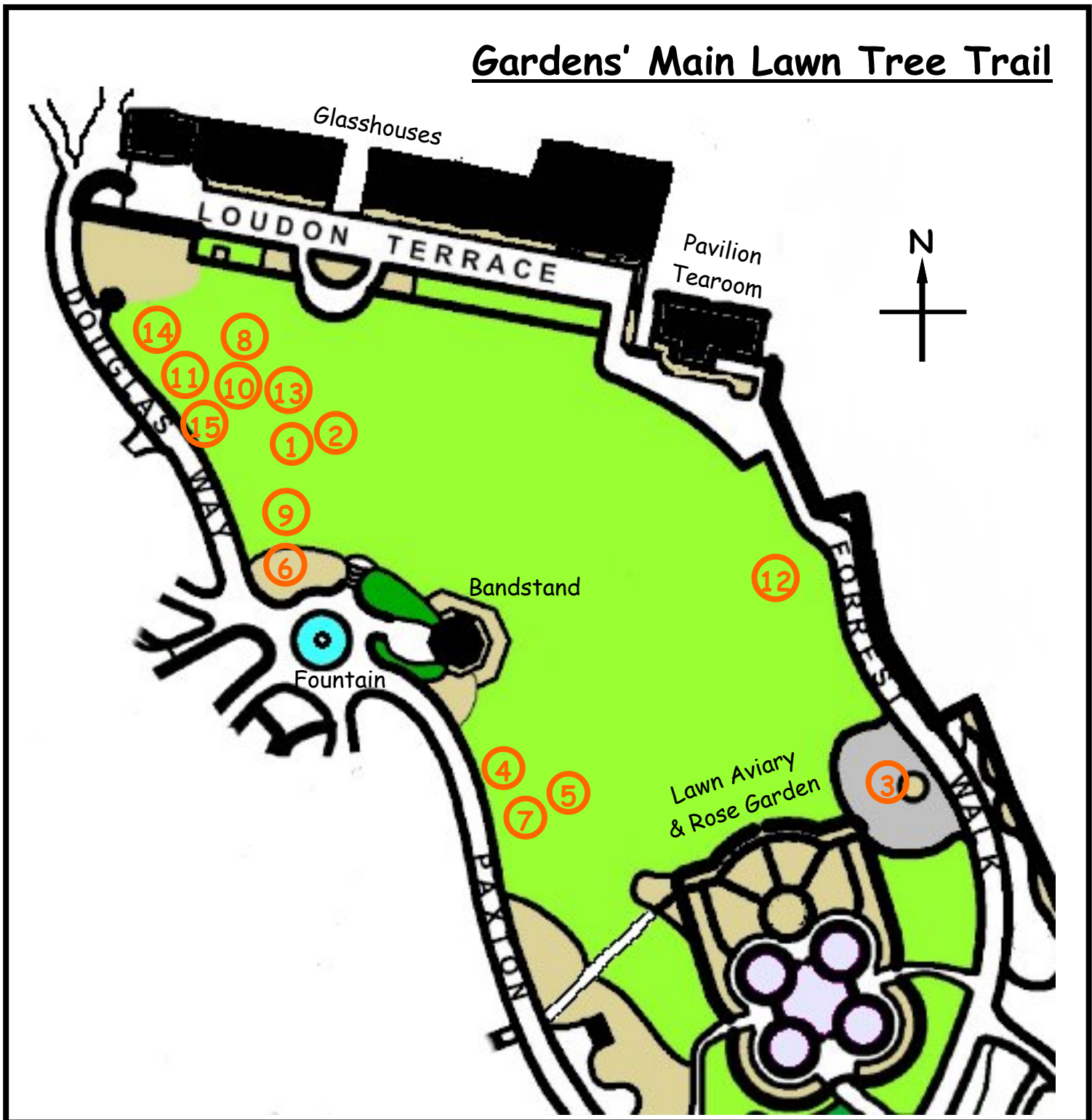

THE BIRMINGHAM BOTANICAL GARDENS & GLASSHOUSES

an independent educational charity

Gardens' Main Lawn Tree Trail



This trail is intended to help teachers and pupils to learn more about some of the Gardens' trees. Covering the Main Lawn, this trail will give you brief descriptions to help with identification.



Trees on the Main Lawn - Teachers' Notes

①



Ginkgo biloba 'Maidenhair Tree'

The word 'Ginkgo' is Chinese; 'gin' = silver and 'kyo' = apricot. Its leaves are divided into two and fossils show they haven't changed for over 200 million years! It is used in herbal remedies and individual trees can live longer than 3000 years.



'Biloba' means divided into 2 lobes: take a close look at its leaves to find out more

②



Metasequoia glyptostroboides

Native to China, this Dawn Redwood tree is one of three conifers known as Redwoods (including the Coastal Redwood and Giant Sequoia). It is fast growing and deciduous.



Is the trunk hard or soft?

③



Fagus sylvatica 'Purpurea'

This Copper Beech tree will turn its leaves to the sun as it is sensitive to light. The nuts it produces are edible but too many are toxic! It has incredibly long buds up to 3cm long.



What colour are its leaves today?

④



Acer rubrum 'Scanlon'

A Canadian Maple of the greatest beauty. It has golden leaves speckled with crimson in the autumn months.



How many points can you count on each leaf?

⑤



Acer rubrum 'October Glory'

This is a Red Maple tree native to Missouri, USA. Its sap can be used to make maple syrup, although it is not as good quality as that obtained from the Sugar Maple.



Its leaves are brightly coloured in autumn - what colour are they today?



6



Betula carpinus 'Tschonoskii'

This Hornbeam has leaves with tooth-like edges. The name Hornbeam comes from 'horn' (due to its hardness) and 'beam' which is Old English for 'a tree'.



Feel its smooth bark

7



Prunus 'Taihaku'

This Great White Cherry is one of the finest of all cherry trees. In spring it is covered with flowers.



Can you see its big, oval leaves?

8



Pinus banksiana

The Jack Pine is widespread in Ontario, Canada. It is used for railway timbers and pulpwood and often blueberry bushes are grown underneath.



See how the leaves are evergreen, long and twisted

9



Abies koriana

The Korean Fir is a small evergreen and coniferous tree. It has smooth bark with resin blisters and is grey-brown in colour.



Look at how the leaves are shaped like needles

10



Nyssa sylvatica

Commonly known as the Black Tupelo, this tree is also known by other names including Blackgum, Sourgum and Beetlebung! Its bark becomes very ridged in old age, resembling alligator hide. Hollow sections of the trunk were formerly used to keep bees in by bee keepers.



What shape are the leaves?



11



Prunus avium 'Plena'

A deciduous tree which is covered in long-lasting pure white flowers in spring.



Take a close look at the patterns in its beautiful bark

12



Prunus 'Pandora'

Another beautiful flowering cherry, it is smothered by pale pink blossom in spring. In autumn its leaves are bronze-red making it very attractive.



Is this tree taller than you?

13



Styrax hemsleyanum

Native to China, this tree has been recently introduced to Britain. Its common name is 'Hemsley Snowball'.



What shape is this tree?

14



Picea breweriana

The Brewer or Weeping Spruce is very rare in its native North America. It is a large evergreen tree that grows very slowly. It droops to shed very heavy snow and ice loads.



Can you find its drooping, tough branches?

15



Pinus ponderosa

The Bull or Western Yellow Pine is found in the Rocky Mountains and Sierra Nevada, USA. It has very distinctive bark; orange in colour with black lining the crevasses where the bark has split.



Can you feel how rough the bark is?